

Material Options			
Part Number	Bar Material	Ball Material	Load Rating
R30-600	AISI 1012 Electrophoretic (Black)	AISI 52100	2800 kg / 6200 lbs
R30-600A	AISI 1012 Electrophoretic (Black)	AISI 420	2800 kg / 6200 lbs
R30-600D	AISI 1012 Electrophoretic (Black)	Acetal (POM)	250 kg / 550 lbs
R30-600SS	AISI 304 - Natural	AISI 420	2000 kg / 4500 lbs

FIXING BRACKET - RB1
OPTIONAL 50 x 25mm
BRACKET MADE FROM
3mm THICK ANGLE

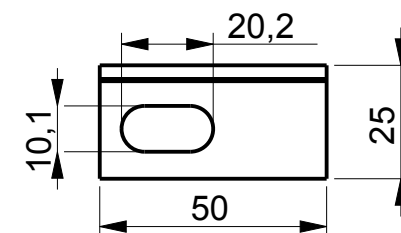

REVISION # 01

ALL DIMENSIONS IN mm [inch]
IF VIEWED AS PDF, DO NOT SCALE
IF VIEWED AS DWG, SCALE x : x
TOLERANCE ± 0,25 [0.01]
QMF 31 ISSUE 02 : 09/01/2017

OMNITRACK
RODBOROUGH COURT
STROUD, GL5 3LR, ENGLAND

Telephone: +44 (0)1453 873 345
Fax: +44 (0)1453 878 500
info @ omnitrack.com
www.omnitrack.com

THIS DOCUMENT CONTAINS OMNITRACK
PROPERTY AND CONFIDENTIAL INFORMATION.
IT IS LOANED FOR LIMITED PURPOSES ONLY
AND REMAINS THE PROPERTY OF OMNITRACK.
IT MAY NOT BE REPRODUCED IN WHOLE
OR PART OR DISCLOSED TO THIRD PARTIES
WITHOUT THE PRIOR WRITTEN CONSENT OF
OMNITRACK. THE DOCUMENT IS TO BE
RETURNED TO OMNITRACK UPON REQUEST
AND IN ALL EVENTS UPON COMPLETION OF THE
USE FOR WHICH IT WAS LOANED